

Installation Manual

Z000000601

Revised 02/13/23

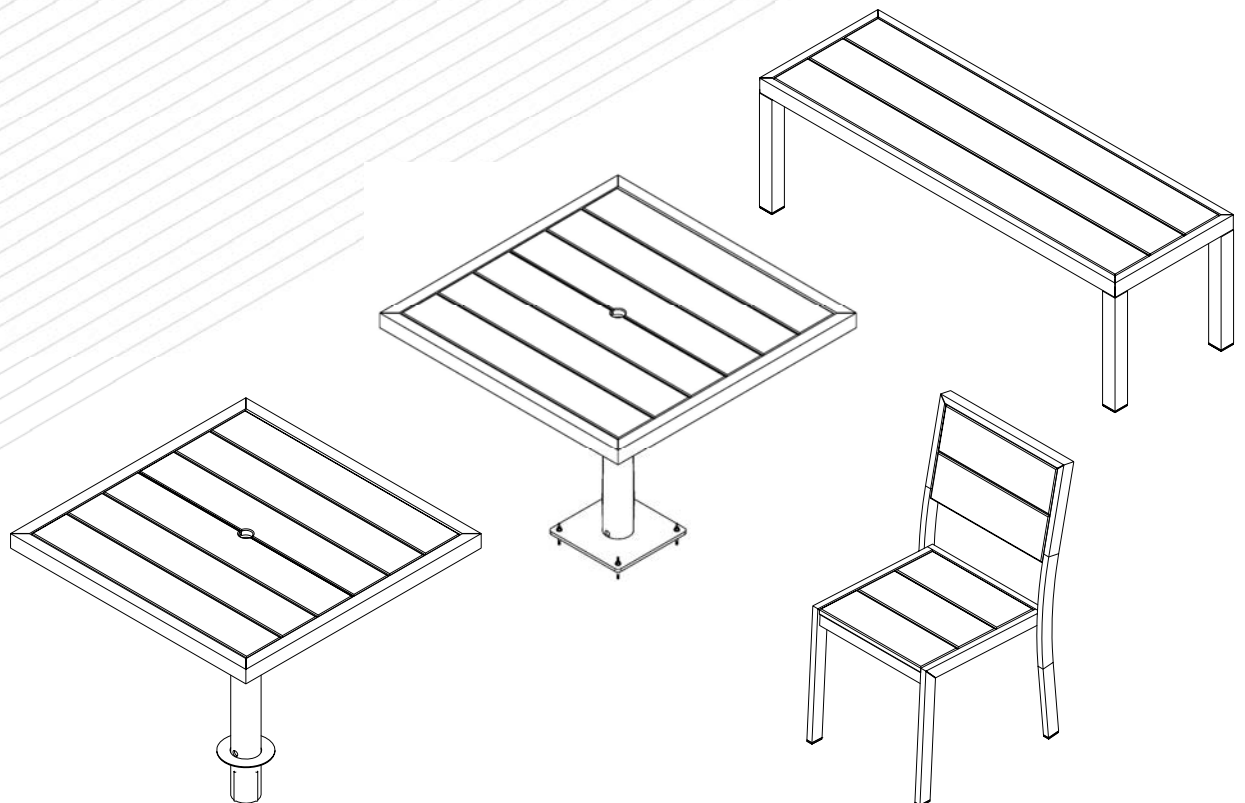

Unpacking Your Shipment

Unpack and identify each component in each box that you received. If your shipment is missing parts, please contact Plymold.

Components

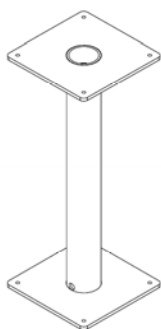

Table Base—Bolt Down

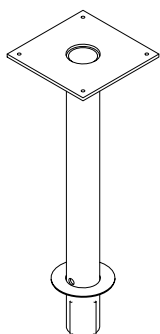

Table Base—Grout In

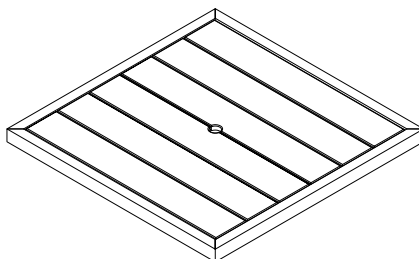
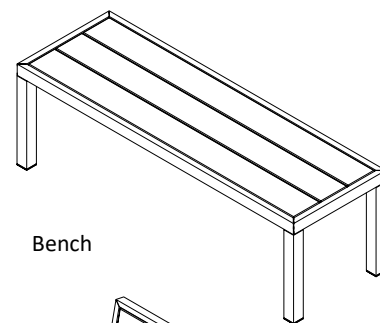
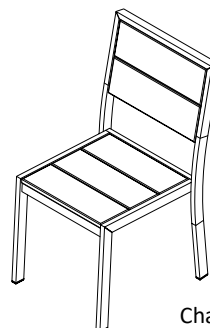

Table Top—Sizes Vary



Bench



Chair

Hardware

Fasten Top to Base

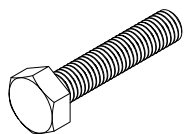

Hex Head Cap Screw
5/16-18 x 1 1/4" L



Nyloc Nut 5/16-18



Washer 5/16"

Umbrella

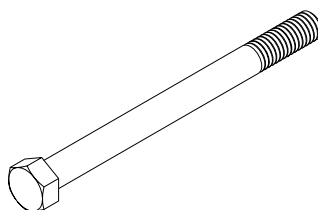

Hex Head Cap Screw
3/8-16 x 4 1/2" L

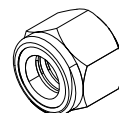

Nyloc Nut 3/8-16



Washer 3/8"

Floor Fastening



Center Pin Anchor
1/4" x 2 3/8"

(Used only with
bolt down post)

Optional Bench/Chair Anchoring Kit (Order Separately)

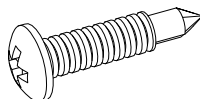

Tek Screw #8 x 3/4"
Phillips Panhead

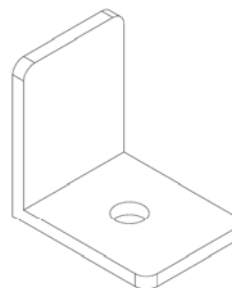

Floor Angle



Nail In Anchor
1/4" x 1 1/2"

Assembly grout in table base

- This product is designed for installation into normal weight concrete.
- **Anchoring cement not provide.** Use Commercial Grade Anchoring cement designed for inter/ exterior use such as commercial grade QWIKRETE No. 1245-11

Step 1: Locating and Cutting Floor Holes

- Determine furniture layout.
- Mark hole locations on floor.
- Using a core drilling machine and a 5" diameter drill bit, drill 7" deep holes in the floor where you marked.
- Remove the core from the floor by inserting a chisel or a screw driver into the bit path in the cement and pound it until the core snaps loose.
- Mix a small portion of anchoring cement per your instructions.
- Pour cement into each hole until a depth of 6" has been reached.
- Let pad harden before moving on.

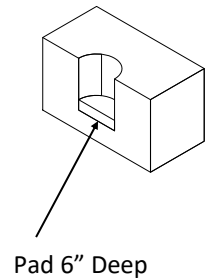

Step 2: Setting and Leveling Post

- Place post core drilled hole in floor to verify flange is flush with floor.
- Place wedges under flange if needed to level and plum post.
Note: Wedges Not Supplied.
- Using a string line as a guide, place Posts as needed.

Step 3: Cementing Posts

- After all posts have been leveled and wedged, mix cement per instructions.
- Remove table post from hole, using a funnel or flexible container, fill holes 3/4 full. Place post back in hole, verify level and plum of post.
- Let concrete set overnight before use.
- Clean posts.

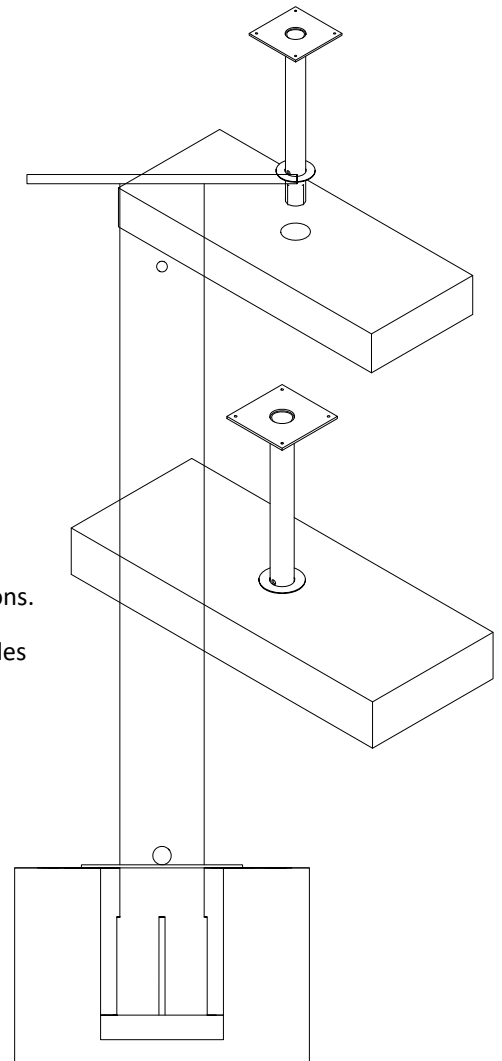

Assembly bolt down table base

* This product is designed for installation into normal weight concrete.

Step 4: Mark floor locations

- a. Layout your table bases according to your layout
- b. Ensure that posts are oriented square to desired table layout. Run a string or line to help with and alignment.
- c. Mark floor fastener locations in floor plate.

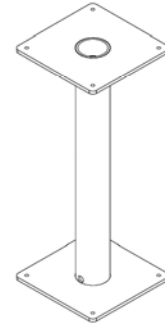

Step 5: Secure table posts to floor

- a. Move you table base off to the side.
- b. Drill a 1/4" diameter hole a minimum of 2-1/2" deep hole in the cement at the marked locations.
- c. Blow out the dust from the holes.
- d. Place the post over the pre-drilled locations, lining up the holes with the pre-drilled holes. Preset the nut and washer for desired embedment and insert the anchor through the fixture into the hole
- e. Hammer center pin until it is aligned with the top of the bolt.
- f. Tighten nut .

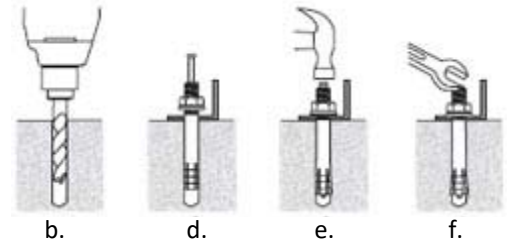

Attach top to table base

Step 6: Attach top to table base

- a. Set top onto your table base.
- b. Fasten top to the table top plate of base using a (4) 5/16"-18 x 1 1/4" Hex Head cap_screw, (8) 5/16" washers and (4)5/16-18 nyloc nuts. See Image for orientation of hardware.

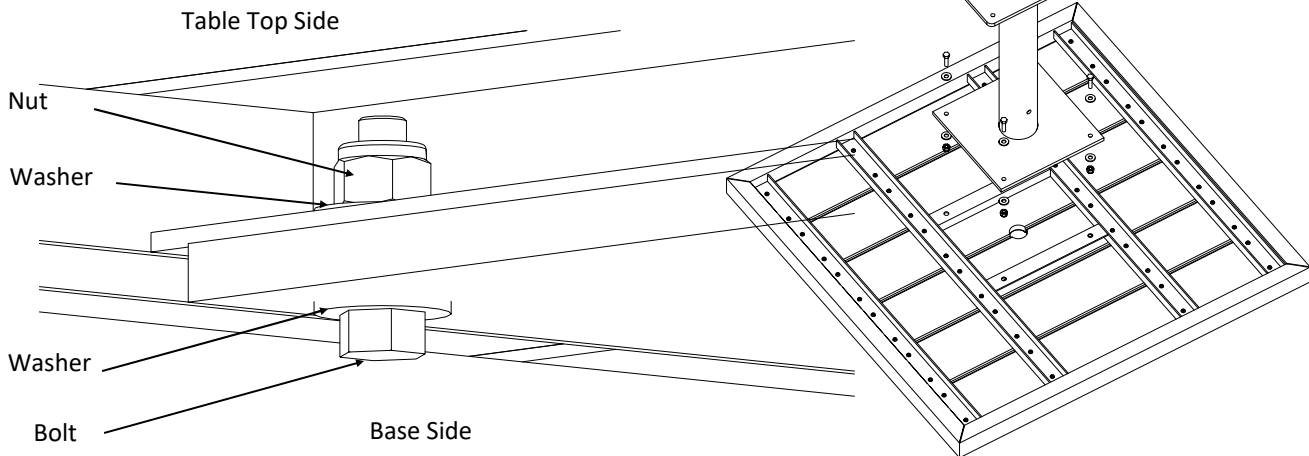

Floor Fasten Bench (Optional Kit)

* This product is designed for installation into normal weight concrete.

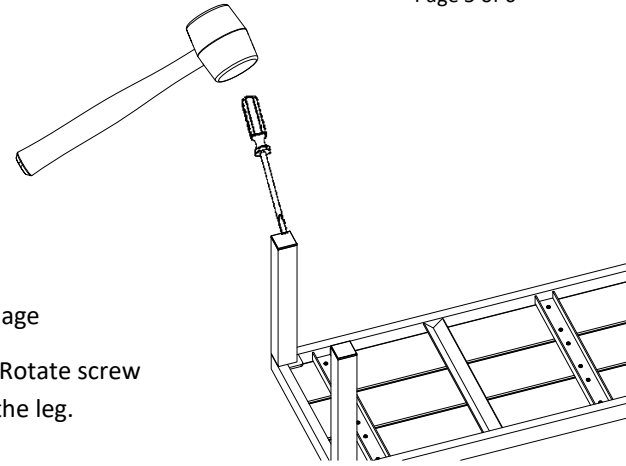

Step 7: Remove Glides

- Place bench/chair face down on a protective surface to prevent damage
- Use a soft mallet to drive a screw driver through face of the glide. Rotate screw driver in a circular motion prying the cap upward to remove it from the leg.

Step 8: Floor Fasten Bench (go to step 9 for chair)

- Set your bench in the final desired location.
- Trace the outside of each leg onto the concrete. Move bench off to the side and draw an 'X' to mark center of each marked leg. 'X' indicates where you will drill your hole.
- Drill a 1/4" diameter hole a minimum of 1-3/4" deep in the cement at marked locations.
- Blow out dust from holes.
- Place the floor angle over pre-drilled locations, lining up the angle hole with pre-drilled hole.
- Insert anchor assembly through mounting hole in fixture and into anchor hole in concrete
- Tap gently until head of anchor body is set tightly against top face of angle. Gently hammer the pin flush to expand the body. Do not overdrive pin into body as this could damage the anchor.
- Place bench back leg over the top of the angle brackets.
- Install (4) #8 x 3/4" philips head tek screw through the bench leg into angle bracket to secure it in place.

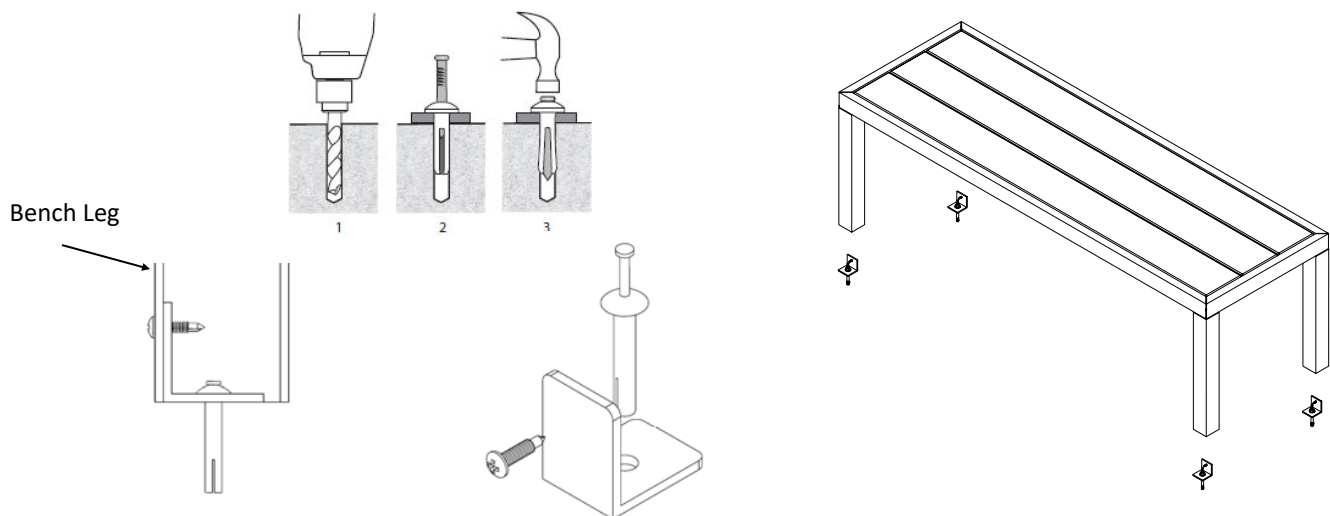

Floor Fasten Chair (Optional Kit)

* This product is designed for installation into normal weight concrete.

Step 9: Floor Fasten Chair

- a. Set your bench or chair in the final desired location.
- b. Place angle up inside the foot of each of your 4 legs.
- c. With chair sitting on ground so angles are square with ground. Install (4) 1/4" washers and (4) #8 x 3/4" philips head tek screw though the chair leg into angle bracket to secure it in place.
- d. Mark locations of holes in brackets onto your cement. Set chair aside.
- e. Drill a 1/4" diameter hole a minimum of 1-3/4" deep in the cement at marked locations.
- f. Blow out dust from holes.
- g. Place the floor angle over pre-drilled locations, lining up the angle hole with pre-drilled hole.
- h. Insert anchor assembly through mounting hole in fixture and into anchor hole in concrete
- i. Tap gently until head of anchor body is set tightly against top face of angle. Gently hammer the pin flush to expand the body. Do not overdrive pin into body as this could damage the anchor.

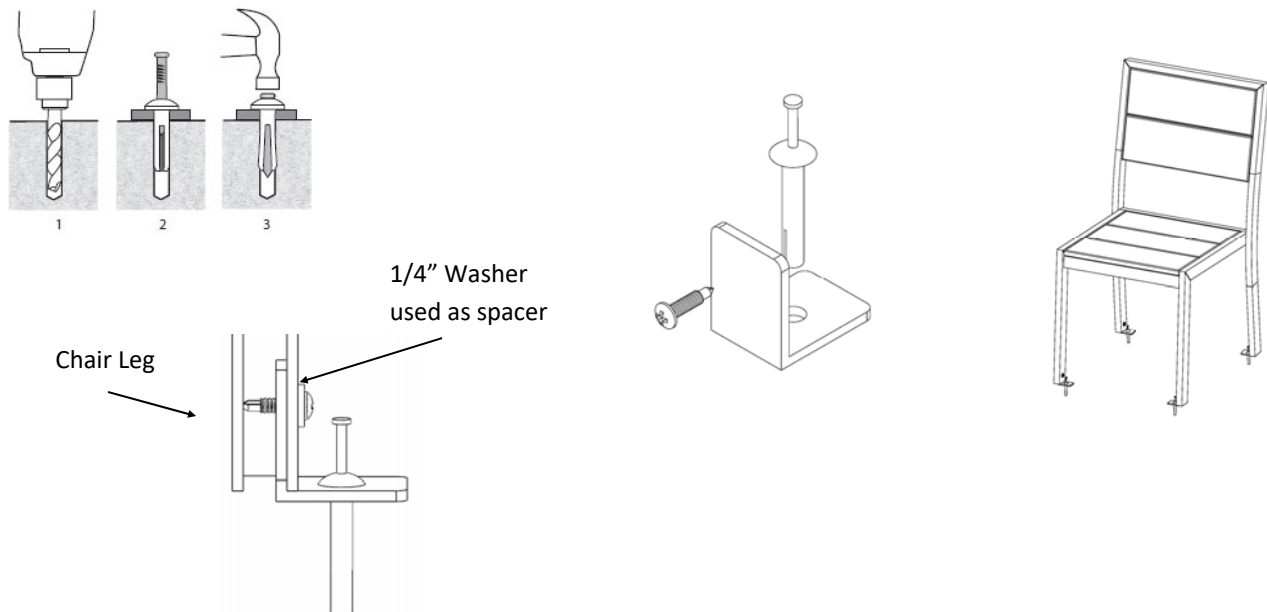

Step 10: Clean furniture and protect unit until ready for use.